



SNOW MOUNTAIN RANCH

YMCA OF THE ROCKIES

Thank you for considering Snow Mountain Ranch for this special day in your lives. We are here to assist you in the planning, booking and coordination of your wedding venues. We offer the following packages:

WEDDING CEREMONY & RECEPTION

- ❖ A one-hour rehearsal at your ceremony site the day before the wedding; and the coordinator's presence at the ceremony to make sure everything runs smoothly for your special day.
- ❖ You'll gain access to your reception venue starting at 3 PM the day before the reception and lasts until 10 AM the day after your wedding. All events must conclude by 10 PM each day.
- ❖ Indoor backup venue for all outdoor wedding ceremony venues hosted on-site in case of inclement weather.
- ❖ Private use of the booked venue, on-site parking, tables and chairs for up to 250 at all of our venues. Chairs are an extra fee of \$1 per chair when Just Ranch is chosen as the ceremony site.
- ❖ Two complimentary lodge rooms for the night before the wedding and the night of the wedding are a-part of this package. There is a variety of free and affordable activities for wedding guests staying overnight at Snow Mountain Ranch.



WEDDING CEREMONY OR RECEPTION

- ❖ Access to your wedding ceremony site or reception site the morning of your event at 10am through the evening of your event at 10pm

CEREMONY VENUES

For your outdoor ceremony, depending on the date of your wedding, you have the choice of:

- ❖ Columbine Point
- ❖ Just Ranch
- ❖ Wildflower Chapel
- ❖ Zachman Family Amphitheater

For an indoor, summer ceremony you may also reserve our Whispering Pines Chapel. Planning a winter wedding? Our winter off-season location choices are Whispering Pines Chapel, our Winter Wedding lot, and any of our indoor reception locations.

COLUMBINE POINT CHAPEL

Surrounded by blooming columbines during the summer and waves of vibrant golden Aspens in the fall, Columbine Point overlooks Pole Creek Valley whilst encompassing the breathtaking views of the Continental Divide. Hosting up to 250 guests.



JUST RANCH

At Just Ranch, you have the flexibility to illustrate the backdrop you've always dreamt about. Seating can be set in the presence of the Golden Aspens, at the base of Snow Mountain or with the Divide luminating in the distance. Chairs are provided. Hosting up to 250 guests.

WHISPERING PINES CHAPEL

This is a lovely venue for those looking for a more traditional setting for their ceremony. Whispering Pines Chapel is also one of the indoor backup options in case the weather doesn't cooperate.

ZACHMAN FAMILY AMPHITHEATER

The Amphitheater sits in the Pole Creek Valley with views of the Continental Divide. This location hosts amphitheater-style bench seating for your guests. Hosting up to 250 guests.

WILDFLOWER CHAPEL

Conveniently located and within walking distance from the Legett Reception Hall, the Chapel offers breathtaking views of the Continental Divide with built in Chapel style benches. Hosting up to 150 guests.

RECEPTION VENUES

For your reception, depending on the date of your wedding, you have the choice of:

- ❖ **Legett Reception Hall**
- ❖ **Mountain Air Cookout Shelter**
- ❖ **Promise Reception Hall**

LEGETT RECEPTION HALL

A beautiful space with wide spread windows in the presence of Just Ranch and the Pole Creek Valley. The outdoor deck allows for expansive mountain views and plentiful wildlife sightings. Hosting up to 250 guests.

- ❖ **Outside Catering Companies Permitted**



PROMISE RECEPTION HALL

Overlooking the Pole Creek Valley, this is an elegant reception venue with expansive views of the everlasting mountains. The crafted wood ceilings and walls provide an upscale western feel, and a spacious outdoor deck is a delightful gathering space for your guests to enjoy. Hosting up to 298 guests.

- ❖ **SMR is the Exclusive Caterer**

MOUNTAIN AIR COOKOUT SHELTER

The Cookout Shelter is the perfect place for a uniquely rustic reception or rehearsal dinner. This location seats your guests at picnic tables and the building can be decorated with lights and themed-wedding décor. Hosting up to 150 guests.

- ❖ **Outside Catering Companies Permitted**

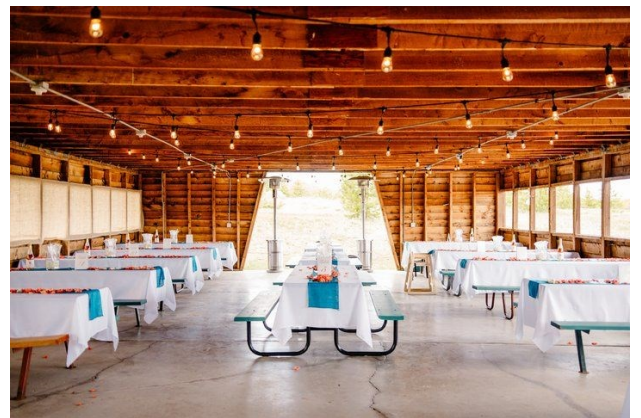

ADDITIONAL INFORMATION

ACCOMMODATIONS

Snow Mountain Ranch offers a variety of accommodation options including;

Room Blocks

3 Hotel-Style Lodges

Retreat Cabins

Up to 42 Guests

Yurts

Seasonal Availability

Campgrounds

Seasonal Availability

Family Cabins

2-5 Bedroom Cabins

CATERING

Snow Mountain Ranch does offer catering services at all of our reception and rehearsal dinner venues. Outside caterers are welcome in Mountain Air Cookout Shelter & Legett Reception Hall. Snow Mountain Ranch Catering are the only caterers permitted in the Promise Reception Hall kitchen. For a copy of our catering guide, or a list of local vendors, please contact our Special Event Venue Coordinator at smrwedding@ymcarockies.org

ALCOHOL

If you are serving alcohol at your reception, it must be provided or contracted by the wedding party. We allow weddings to serve beer, wine and champagne on Snow Mountain Ranch property. Licensed bartenders, or a family friend that is TIPS certified, is required to serve alcohol to guests.

SOCIAL MEDIA

To review more photos of our property, please visit:

- ❖ **Instagram: snowmountainranch**
- ❖ **Ymcarockies.org**

CONTACT US

If you have any additional questions or would like to schedule a walk-through, please contact our Special Event Venue Coordinator at smrwedding@ymcarockies.org or call 970-887-2152 x 4128.



SNOW MOUNTAIN RANCH

Columbine Point

PLANNING PACKET

2024 – 2025





SNOW MOUNTAIN RANCH

Columbine Point

Wedding Planning Packet

CONTENTS

<i>Ceremony Planning Information</i>	<i>3</i>
<i>Amenities & Equipment</i>	<i>4</i>
<i>Additional Reservation Details</i>	<i>5</i>
<i>Programs & Activities</i>	<i>6</i>
<i>Transportation & Accommodations</i>	<i>6</i>
<i>Columbine Point Measurements</i>	<i>7</i>
<i>Contact & Social Media</i>	<i>8</i>



CEREMONY PLANNING INFORMATION

*Includes use of wooden benches seating up to 250 guests

*Bathrooms include a mobile toilet located near the parking lot

*NO smoking around the ceremony venue

*NO alcohol is permitted at Columbine Point, only inside of the reception venues



Decoration Guidelines

We do not allow any form of open flame candles, unity candles and sparklers included. We encourage the use of battery powered candles for the safety and security of your wedding.



AMENITIES & EQUIPMENT

*We offer audio visual rentals as well as additional equipment based on availability, please ask Special Event Venue Coordinator or Special Events Associate for equipment list, availability and pricing. See below for additional amenities.

Champagne Flutes & Wine Glasses

\$1 / Glass

Ice Orders & Delivery

\$4 / 10LB Bag

Dance Floor

9x9 \$150

12x12 \$200

15x15 \$250

18x18 \$300

21x21 \$350

Refrigeration

*We currently offer a shared walk-in sized cooler for use by weddings located in the Administration Building. Items must be labeled and Special Event Venue Coordinator or Associate must approve prior to drop off of goods.

All rental items must be requested 2 weeks in advance



ADDITIONAL RESERVATION DETAILS

Fire Rings

Fire rings can be reserved by wedding groups, based upon availability. The reservation is \$30 and includes 1 bundle of wood and matches. Additional tables and chairs, as well as grills, can be rented for use at level-grounded fire rings.

**Fire rings cannot be reserved when under a fire ban.*

**Quiet hours of 10pm apply.*

**Alcohol is not permitted at reserved fire rings.*

Rehearsal Dinner

Venue and amenities for rehearsal dinners are not included in your site fees. We do have venues that weddings often use for rehearsal dinners on property.

**Please inquire with our Special Event Venue Coordinator regarding pricing and availability.*

Bridal Party Complimentary Rooms

If you have purchased a ceremony and reception package with us, we would love to provide you with two complimentary lodge rooms for you and your party to use for wedding preparation.

**Please inquire with Special Event Venue Coordinator regarding availability.*



PROGRAMS & ACTIVITIES

If you would like to book individual or group activities such as our summer tubing hill, zip line, yoga, climbing wall, fishing or biking, please contact our Programs Department @ (970) 887 – 2152 ext. 4135

TRANSPORTATION

Snow Mountain Ranch does not provide any transportation to, from or while on the property. We recommend Home James Transportation for your guests to travel from Denver International Airport to our location as well as personalized shuttle service. Lift provides transportation within the Grand County area.

ACCOMMODATIONS, CONTRACTS & POLICIES

Please refer to your lodging contracts to see room block drop dates and cancellation schedules.

Room Blocks

3 Hotel-Style Lodges

Retreat Cabins

6-8 Bedrooms & Up to 42 Guests

Yurts & Campgrounds

Seasonal Availability

Family Cabins

2-5 Bedrooms



COLUMBINE POINT MEASUREMENTS

Benches

of Benches per Side: 10

Length of Benches: 26.6ft

Gazebo

Interior Sides: 4.5ft

15' Diameter

Aisle

Gazebo to Commencement: 88ft

Backrow Benches to Commencement: 53ft

Gazebo to Benches: 35ft

Aisle Width: 8.4ft

Parking

Parking is available in small parking lot upon arriving to Columbine as well as the entire grass lot behind the gazebo.



CONTACTING YOUR SPECIAL EVENT VENUE COORDINATOR

To contact your Special Event Venue Coordinator or Associate,
please call or email at

(970) 887 – 2152 ext. 4128

smrwedding@ymcarockies.org.

If you need urgent assistance on the day of your wedding, please call the Front Desk at (970) 887 – 2152 ext. 0, tell them your issue or concern and they will contact your Venue Coordinator via radio or cell phone.

To view photos of our property, please visit:

ymcarockies.org

Instagram: snowmountainranch



SNOW MOUNTAIN RANCH

Just Ranch

PLANNING PACKET

2024 – 2025





SNOW MOUNTAIN RANCH

Just Ranch

Wedding Planning Packet

CONTENTS

<i>Ceremony Planning Information</i>	<i>3</i>
<i>Amenities & Equipment</i>	<i>4</i>
<i>Additional Reservation Details</i>	<i>5</i>
<i>Programs & Activities</i>	<i>6</i>
<i>Transportation & Accommodations</i>	<i>6</i>
<i>Contact & Social Media</i>	<i>7</i>



CEREMONY PLANNING INFORMATION

*Includes the use of white resin chairs, comfortably seating up to 200 guests

*Bathrooms include a mobile toilet located near the parking lot

*NO smoking around the ceremony venue

*NO alcohol is permitted at Just Ranch, only inside of the reception venues



Decoration Guidelines

We do not allow any form of open flame candles, unity candles and sparklers included. We encourage the use of battery powered candles for the safety and security of your wedding.



AMENITIES & EQUIPMENT

*We offer audio visual rentals as well as additional equipment based on availability, please ask Special Event Venue Coordinator or Special Events Associate for equipment list, availability and pricing. See below for additional amenities.

Champagne Flutes & Wine Glasses

\$1 / Glass

Ice Orders & Delivery

\$4 / 10LB Bag

Dance Floor

9x9 \$150

12x12 \$200

15x15 \$250

18x18 \$300

21x21 \$350

Refrigeration

*We currently offer a shared walk-in sized cooler for use by weddings located in the Administration Building. Items must be labeled and Special Event Venue Coordinator or Associate must approve prior to drop off of goods.

All rental items must be requested 2 weeks in advance



ADDITIONAL RESERVATION DETAILS

Fire Rings

Fire rings can be reserved by wedding groups, based upon availability. The reservation is \$30 and includes 1 bundle of wood and matches. Additional tables and chairs, as well as grills, can be rented for use at level-grounded fire rings.

**Fire rings cannot be reserved when under a fire ban.*

**Quiet hours of 10pm apply.*

**Alcohol is not permitted at reserved fire rings.*

Rehearsal Dinner

Venue and amenities for rehearsal dinners are not included in your site fees. We do have venues that weddings often use for rehearsal dinners on property.

**Please inquire with our Special Event Venue Coordinator regarding pricing and availability.*

Bridal Party Complimentary Rooms

If you have purchased a ceremony and reception package with us, we would love to provide you with two complimentary lodge rooms for you and your party to use for wedding preparation.

**Please inquire with Special Event Venue Coordinator regarding availability.*



PROGRAMS & ACTIVITIES

If you would like to book individual or group activities such as our summer tubing hill, zip line, yoga, climbing wall, fishing or biking, please contact our Programs Department @ (970) 887 – 2152 ext. 4135

TRANSPORTATION

Snow Mountain Ranch does not provide any transportation to or from the property. We recommend Home James Transportation for your guests to travel from Denver International Airport to our location as well as personalized shuttle service. Lift provides transportation within the Grand County area.

ACCOMMODATIONS, CONTRACTS & POLICIES

Please refer to your lodging contracts to see room block drop dates and cancellation schedules.

Room Blocks

3 Hotel-Style Lodges

Retreat Cabins

6-8 Bedrooms & Up to 42 Guests

Yurts & Campgrounds

Seasonal Availability

Family Cabins

2-5 Bedrooms



CONTACTING YOUR SPECIAL EVENT VENUE COORDINATOR

To contact your Special Event Venue Coordinator or Associate,
please call or email at

(970) 887 – 2152 ext. 4128

smrwedding@ymcarockies.org.

If you need urgent assistance on the day of your wedding, please call the Front Desk at (970) 887 – 2152 ext. 0, tell them your issue or concern and they will contact your Venue Coordinator via radio or cell phone.

To view photos of our property, please visit:

ymcarockies.org

Instagram: snowmountainranch



SNOW MOUNTAIN RANCH

Legett

PLANNING PACKET

2024 – 2025





SNOW MOUNTAIN RANCH

Legett

Reception Planning Packet

CONTENTS

<i>Reception Planning Information</i>	<i>3</i>
<i>Amenities & Equipment</i>	<i>4-5</i>
<i>Additional Reservation Details</i>	<i>6</i>
<i>Programs & Activities</i>	<i>7</i>
<i>Transportation & Accommodations</i>	<i>8</i>
<i>Contact & Social Media</i>	<i>9</i>



RECEPTION PLANNING INFORMATION

- *250 People max capacity
- *1 household sized refrigerator, sink & counter top. Portable bar
- *NO use of SMR catering in Legett. Outside caterers allowed
- *NO smoking allowed inside facilities or on back deck. Smoking in the parking lot is permitted
- *Please request Legett Planning Sheet for additional dimensions
- *Please view our rental fees on page 4



Decoration Guidelines

There are currently white cords on the ceiling of Legett for your use. You may string lights or decorations on these cords. We do not allow any form of open flame candles, unity candles and sparklers included. We encourage the use of battery powered candles for the safety and security of your wedding. Nothing should be attached directly to the wall or ceiling. Any staples or tacks put into the walls or ceiling subject you to additional service charges and fees. Nails, screws or hooks with a screw end are not allowed. Nothing should be tied or fastened to the lights, sprinkler heads, smoke detectors, or speakers.



AMENITIES & EQUIPMENT

*We offer audio visual rentals as well as additional equipment based on availability, please ask the Special Event Venue Coordinator or Special Events Associate for equipment list, availability and pricing. See below for additional amenities.

Champagne Flutes & Wine Glasses

\$1 / Glass

Ice Orders & Delivery

\$4 / 10LB Bag

Dance Floor

9x9 \$150

12x12 \$200

15x15 \$250

18x18 \$300

21x21 \$350

Refrigeration

*We currently offer a shared walk-in sized cooler for use by weddings located in the Administration Building. Items must be labeled and Special Event Venue Coordinator or Associate must approve prior to drop off of goods.

All rental items must be requested 2 weeks in advance



AMENITIES & EQUIPMENT CONTINUED

Chairs in Legett: White resin chairs are included with Legett pricing. There is no discount for not using these chairs. Tables are included with the Legett building.

Tables: If your reception space includes tables, these are the following table sizes we have available. Standard guest tables are 8' banquet (rectangles) or 5' round tables. Linen sizes are estimates; SMR does not rent linens, they must be purchased from an outside organization.

STANDARD GUEST TABLE SIZES

8' Banquet (rectangle) tables:

8' long
30" wide
29" tall
2" table top depth

Floor length linen size: 90"x156"

5' round tables:

5' diameter
29" tall

2" table top depth

Floor length linen size: 120" round

4' square tables:

4' wide
4' long
29" tall

High-tops:

3' diameter
4' tall
2" table top depth

6' rectangle tables:

6' long
3' wide
29" tall
2" table top depth
Floor length linen size 90"x132"



ADDITIONAL RESERVATION DETAILS

Fire Rings

Fire rings can be reserved by wedding groups, based upon availability. The reservation is \$30 and includes 1 bundle of wood and matches. Additional tables and chairs, as well as grills, can be rented for use at leveled-ground fire rings.

**Fire rings cannot be reserved when under a fire ban.*

**Quiet hours of 10pm apply.*

**Alcohol is not permitted at reserved fire rings.*

Rehearsal Dinner

Venue and amenities for rehearsal dinners are not included in your site fees. We do have venues that weddings often use for rehearsal dinners on property.

**Please inquire with our Special Event Venue Coordinator regarding pricing and availability.*

Bridal Party Complimentary Rooms

If you have purchased a ceremony and reception package with us, we would love to provide you with two complimentary lodge rooms for you and your party to use for wedding preparation.

**Please inquire with Special Event Venue Coordinator regarding availability.*



PROGRAMS & ACTIVITIES

If you would like to book individual or group activities such as our summer tubing hill, zip line, yoga, climbing wall, fishing or biking, please contact our Programs Department @ (970) 887 – 2152 ext. 4135

TRANSPORTATION

Snow Mountain Ranch does not provide any transportation to or from the property. We recommend Home James Transportation for your guests to travel from Denver International Airport to our location as well as personalized shuttle service. The Lift provides transportation within the Grand County area.

ACCOMMODATIONS, CONTRACTS & POLICIES

Please refer to your lodging contracts to see room block drop dates and cancellation schedules.

Room Blocks

3 Hotel-Style Lodges

Retreat Cabins

6-8 Bedrooms & Up to 42 Guests

Yurts & Campgrounds

Seasonal Availability

Family Cabins

2-5 Bedrooms



ACCOMMODATIONS CONTINUED

How your guests can make reservations: If you have reserved room blocks for your guests, you will receive an internet link to pass on to your guests. Your guests can book lodging through this link and be added to your wedding roster. If they'd like to reserve a yurt or a campsite, they will need to call into Central Reservations after January 1st. Yurts and campsites are only available during the summer months, and if the weather holds, into September. The first Wednesday in April is when cabins become available for booking (check our website for exact dates). Reunion size cabins (6-8 bedroom) must be reserved through YOUR Special Event Venue Coordinator. Your guests can also book rooms through Central Reservations at 1-888-613-9622; if you have a contracted wedding block, it is important for them to mention the wedding group name to be added to the roster.

Please note that none of the lodging or event spaces have air conditioning; this is standard for venues at high altitudes.

Contracts & Policies: Please refer to your lodging contracts to see block drop dates and cancellation dates. **Check-in time is at 6pm, check-out time is at 10 am.** Please call the front desk after 8:00 am on the day of check-in if you would like a time estimate of when your cabin will be ready for check-in. Late check-outs will only be granted the day of check-out. To request a late check-out, you may call the front desk on the day of check-out and based on booking they will let you know if they can approve a late check-out for your cabin. The latest check-out time that may be requested is noon.

Important Information for You & Your Guests: Check-in time is at 6pm; if your wedding is earlier than check-in time you may want to encourage your guests to arrive a day early or to arrive ready for the wedding. Specific lodging information, such as room numbers or cabin names, are not guaranteed until check-in. This policy is in place due to the unknown emergencies that could arise and cause SMR staff to need to move cabin reservations around. Also, all rooms are smoke free; this is including any tobacco, marijuana, vape, etc.

If you have any issues or need anything during your stay, please contact the front desk for assistance, or call the number your Wedding Coordinator has provided.



CONTACTING YOUR SPECIAL EVENT VENUE COORDINATOR

To contact your Special Event Venue Coordinator or Associate,
please call or email at

(970) 887 – 2152 ext. 4128

smrwedding@ymcarockies.org.

If you need urgent assistance on the day of your wedding, please call the Front Desk at (970) 887 – 2152 ext. 0, tell them your issue or concern and they will contact your Venue Coordinator via radio or cell phone.

To view photos of our property, please visit:

ymcarockies.org

Instagram: snowmountainranch

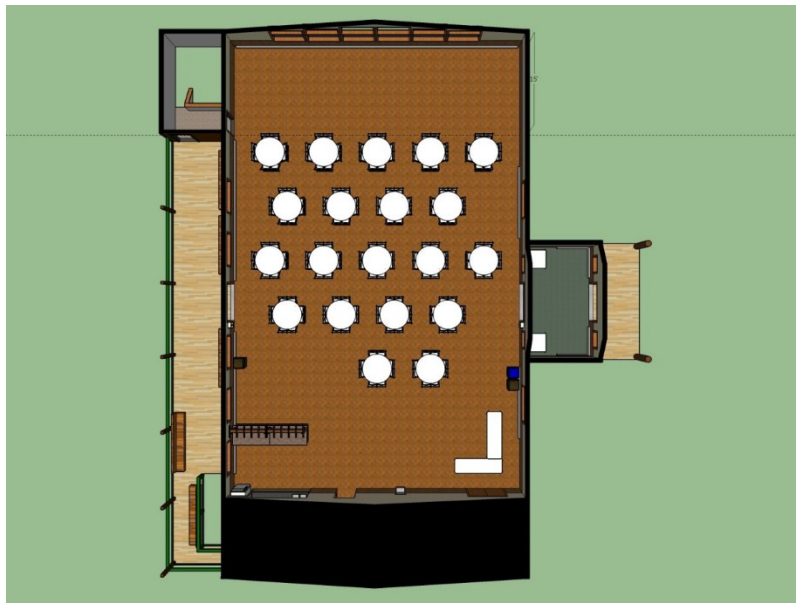
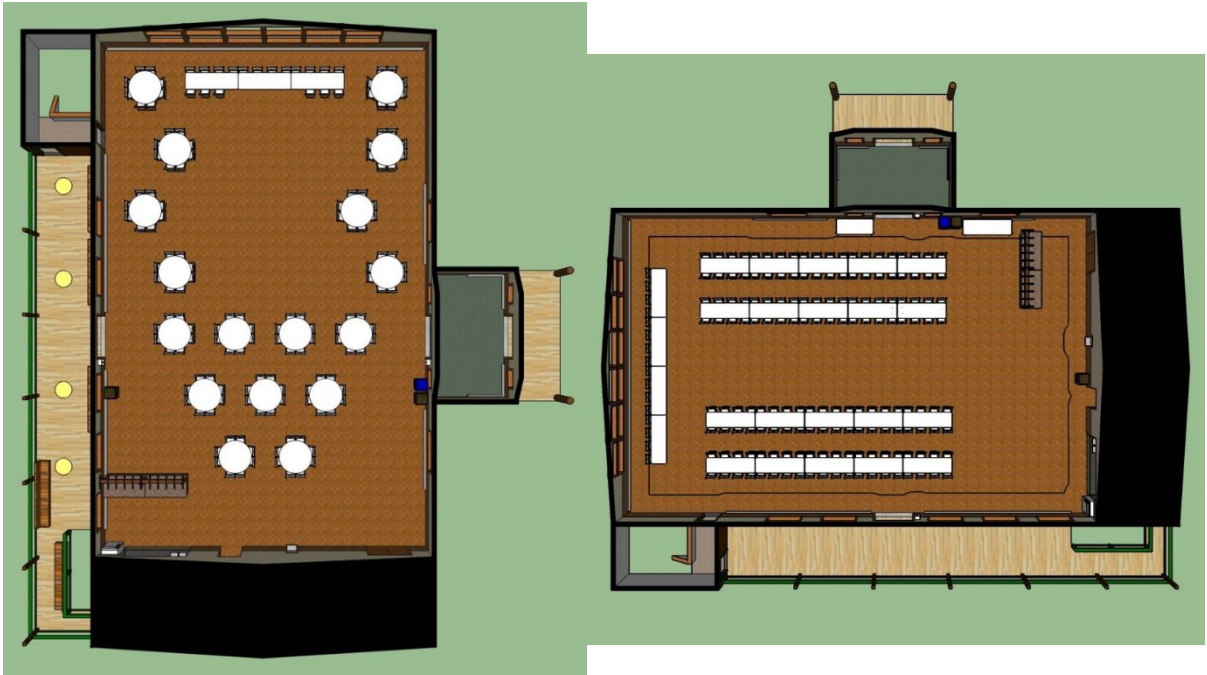



SNOW MOUNTAIN RANCH

Mountain Air

Cookout Shelter

PLANNING PACKET

2024 – 2025





SNOW MOUNTAIN RANCH

Mountain Air Cookout Shelter

Wedding Planning Packet

CONTENTS

<i>Ceremony Planning Information</i>	<i>3</i>
<i>Amenities & Equipment</i>	<i>4</i>
<i>Additional Reservation Details</i>	<i>5</i>
<i>Programs & Activities</i>	<i>6</i>
<i>Transportation & Accommodations</i>	<i>6</i>
<i>MACS Dimensions</i>	<i>7</i>
<i>Contact & Social Media</i>	<i>8</i>



REHEARSAL OR RECEPTION PLANNING INFORMATION

*Kitchen includes sink, counter, grill and picnic tables. Additional tables and chairs can be supplied upon request

*Bathrooms include a mobile toilet located near the parking lot. Walking distance to indoor toilets located in the Administration building



*NO air conditioning or heat. Has power & water, although not guaranteed, depending on time of year

Picnic Table Information: Not all of the picnic tables are guaranteed to be exactly the same. Often, they break or weather too much and have to be replaced. The space usually has 18 picnic tables. Picnic tables can seat 8-10 guests per table.

Approximate Dimensions of Picnic Tables:

Length of tables & benches 8'

Width of tables 2'3"

Width of Benches 8.5"

Tables often covered with linens approximate size 10'x4.5-5' (not to floor) or table runners.



AMENITIES & EQUIPMENT

*We offer audio visual rentals as well as additional equipment based on availability, please ask Special Event Venue Coordinator or Special Events Associate for equipment list, availability and pricing. See below for additional amenities.

Champagne Flutes & Wine Glasses

\$1 / Glass

Ice Orders & Delivery

\$4 / 10LB Bag

Dance Floor

9x9 \$150

12x12 \$200

15x15 \$250

18x18 \$300

21x21 \$350

Refrigeration

*We currently offer a shared walk-in sized cooler for use by weddings located in the Administration Building. Items must be labeled and Special Event Venue Coordinator or Associate must approve prior to drop off of goods.

All rental items must be requested 2 weeks in advance



ADDITIONAL RESERVATION DETAILS

Fire Rings

Fire rings can be reserved by wedding groups, based upon availability. The reservation is \$30 and includes 1 bundle of wood and matches. Additional tables and chairs, as well as grills, can be rented for use at level-grounded fire rings.

**Fire rings cannot be reserved when under a fire ban.*

**Quiet hours of 10pm apply.*

**Alcohol is not permitted at reserved fire rings.*

Rehearsal Dinner

Venue and amenities for rehearsal dinners are not included in your site fees. We do have venues that weddings often use for rehearsal dinners on property.

**Please inquire with our Special Event Venue Coordinator regarding pricing and availability.*

Bridal Party Complimentary Rooms

If you have purchased a ceremony and reception package with us, we would love to provide you with two complimentary lodge rooms for you and your party to use for wedding preparation.

**Please inquire with Special Event Venue Coordinator regarding availability.*



PROGRAMS & ACTIVITIES

If you would like to book individual or group activities such as our summer tubing hill, zip line, yoga, climbing wall, fishing or biking, please contact our Programs Department @ (970) 887 – 2152 ext. 4135

TRANSPORTATION

Snow Mountain Ranch does not provide any transportation to, from or while on the property. We recommend Home James Transportation for your guests to travel from Denver International Airport to our location as well as personalized shuttle service. Lift provides transportation within the Grand County area.

ACCOMMODATIONS, CONTRACTS & POLICIES

Please refer to your lodging contracts to see room block drop dates and cancellation schedules.

Room Blocks

3 Hotel-Style Lodges

Retreat Cabins

6-8 Bedrooms & Up to 42 Guests

Yurts & Campgrounds

Seasonal Availability

Family Cabins

2-5 Bedrooms



DIMENSIONS

12' Opening

28 Windows

51' Wall

16' long

8' Ceiling Height

Approximate Width Overall 30'
Approximate Length Overall 103'

~18 Picnic Tables

44.5" Opening

47' Wall

 = approx 13 Windows
Windows: 27"W x 35"L
(41" from floor to bottom of window)

24 Windows





CONTACTING YOUR SPECIAL EVENT VENUE COORDINATOR

To contact your Special Event Venue Coordinator or Associate,
please call or email at

(970) 887 – 2152 ext. 4128

smrwedding@ymcarockies.org.

If you need urgent assistance on the day of your wedding, please
call the Front Desk at (970) 887 – 2152 ext. 0, tell them your issue
or concern and they will contact your Venue Coordinator via radio
or cell phone.

To view photos of our property, please visit:

ymcarockies.org

Instagram: snowmountainranch



SNOW MOUNTAIN RANCH

Promise

PLANNING PACKET

2024 – 2025





SNOW MOUNTAIN RANCH

Promise

Reception Planning Packet

CONTENTS

<i>Reception Planning Information</i>	<i>3</i>
<i>Amenities & Equipment</i>	<i>4-5</i>
<i>Additional Reservation Details</i>	<i>6</i>
<i>Programs & Activities</i>	<i>7</i>
<i>Transportation & Accommodations</i>	<i>8</i>
<i>Contact</i>	<i>9</i>



RECEPTION PLANNING INFORMATION

- *200 People max capacity
- *Counter and sink located directly inside front doors
- *Promise kitchen can only be utilized by Snow Mountain Ranch Catering
- *NO smoking allowed inside facilities or on back deck. Smoking in the parking lot is permitted
- *Please request Promise Planning Sheet for additional dimensions
- *A dance floor is required. Please view our rental fees on page 4

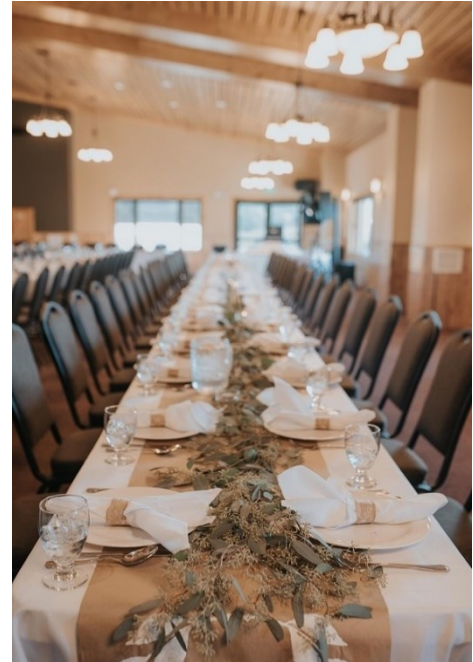

Decoration Guidelines

We do not allow any form of open flame candles, unity candles and sparklers included. We encourage the use of battery powered candles for the safety and security of your wedding. Nothing should be attached directly to the wall or ceiling. Any staples or tacks put into the walls or ceiling subject you to additional service charges and fees. Nails, screws or hooks with a screw end are not allowed. Nothing should be tied or fastened to the lights, sprinkler heads, smoke detectors, or speakers.





AMENITIES & EQUIPMENT

*We offer audio visual rentals as well as additional equipment based on availability, please ask the Special Event Venue Coordinator or Special Events Associate for equipment list, availability and pricing. See below for additional amenities.

Champagne Flutes & Wine Glasses

\$1 / Glass

Ice Orders & Delivery

\$4 / 10LB Bag

Dance Floor

9x9 \$150

12x12 \$200

15x15 \$250

18x18 \$300

21x21 \$350

Refrigeration

*We currently offer a shared walk-in sized cooler for use by weddings located in the Administration Building. Items must be labeled and Special Event Venue Coordinator or Associate must approve prior to drop off of goods.

All rental items must be requested 2 weeks in advance



AMENITIES & EQUIPMENT CONTINUED

Chairs in Promise: The chairs in the picture above are included with Promise pricing. There is no discount for not using these chairs. Tables are included with the Promise building.

Tables: If your reception space includes tables, these are the following table sizes we have available. Standard guest tables are 8' banquet (rectangles) or 6' round tables. Linen sizes are estimates; SMR does not rent linens, they must be purchased from an outside organization.

STANDARD GUEST TABLE SIZES

8' Banquet (rectangle) tables:

8' long
30" wide
29" tall
2" table top depth

Floor length linen size: 90"x156"

6' round tables:

6' diameter
29" tall

2" table top depth

Floor length linen size: 132" round

4' square tables:

4' wide
4' long
29" tall

High-tops:

3' diameter
4' tall
2" table top depth

6' rectangle tables:

6' long
3' wide
29" tall
2" table top depth
Floor length linen size 90"x132"



ADDITIONAL RESERVATION DETAILS

Fire Rings

Fire rings can be reserved by wedding groups, based upon availability. The reservation is \$30 and includes 1 bundle of wood and matches. Additional tables and chairs, as well as grills, can be rented for use at fire rings.

**Fire rings cannot be reserved when under a fire ban.*

**Quiet hours of 10pm apply.*

**Alcohol is not permitted at reserved fire rings.*

Rehearsal Dinner

Venue and amenities for rehearsal dinners are not included in your site fees. We do have venues that weddings often use for rehearsal dinners on property.

**Please inquire with our Special Event Venue Coordinator regarding pricing and availability.*

Bridal Party Complimentary Rooms

If you have purchased a ceremony and reception package with us, we would love to provide you with two complimentary lodge rooms for you and your party to use for wedding preparation.

**Please inquire with Special Event Venue Coordinator regarding availability.*



PROGRAMS & ACTIVITIES

If you would like to book individual or group activities such as our summer tubing hill, zip line, yoga, climbing wall, fishing or biking, please contact our Programs Department @ (970) 887 – 2152 ext. 4135

TRANSPORTATION

Snow Mountain Ranch does not provide any transportation to or from the property. We recommend Home James Transportation for your guests to travel from Denver International Airport to our location as well as personalized shuttle service. Lift provides transportation within the Grand County area.

ACCOMMODATIONS, CONTRACTS & POLICIES

Please refer to your lodging contracts to see room block drop dates and cancellation schedules.

Room Blocks

3 Hotel-Style Lodges

Retreat Cabins

6-8 Bedrooms & Up to 42 Guests

Yurts & Campgrounds

Seasonal Availability

Family Cabins

2-5 Bedrooms



ACCOMMODATIONS CONTINUED

How your guests can make reservations: If you have reserved room blocks for your guests, you will receive an internet link to pass on to your guests. Your guests can book lodging through this link and be added to your wedding roster. If they'd like to reserve a yurt or a campsite, they will need to call into Central Reservations after January 1st. Yurts and campsites are only available during the summer months, and if the weather holds, into September. The first Wednesday in April is when cabins become available for booking (check our website for exact dates). Reunion size cabins (6-8 bedroom) must be reserved through YOUR Special Event Venue Coordinator. Your guests can also book rooms through Central Reservations at 1-888-613-9622; if you have a contracted wedding block, it is important for them to mention the wedding group name to be added to the roster.

Please note that none of the lodging or event spaces have air conditioning; this is standard for venues at high altitudes.

Contracts & Policies: Please refer to your lodging contracts to see block drop dates and cancellation dates. **Check-in time is at 6pm, check-out time is at 10 am.** Please call the front desk after 8:00 am on the day of check-in if you would like a time estimate of when your cabin will be ready for check-in. Late check-outs will only be granted the day of check-out. To request a late check-out, you may call the front desk on the day of check-out and based on booking they will let you know if they can approve a late check-out for your cabin. The latest check-out time that may be requested is noon.

Important Information for You & Your Guests: Check-in time is at 6pm; if your wedding is earlier than check-in time you may want to encourage your guests to arrive a day early or to arrive ready for the wedding. Specific lodging information, such as room numbers or cabin names, are not guaranteed until check-in. This policy is in place due to the unknown emergencies that could arise and cause SMR staff to need to move cabin reservations around. Also, all rooms are smoke free; this is including any tobacco, marijuana, vape, etc.

If you have any issues or need anything during your stay, please contact the front desk for assistance, or call the number your Wedding Coordinator has provided.



CONTACTING YOUR SPECIAL EVENT VENUE COORDINATOR

To contact your Special Event Venue Coordinator or Associate,
please call or email at

(970) 887 – 2152 ext. 4128

smrwedding@ymcarockies.org.

If you need urgent assistance on the day of your wedding, please call the Front Desk at (970) 887 – 2152 ext. 0, tell them your issue or concern and they will contact your Venue Coordinator via radio or cell phone.

To view photos of our property, please visit:

ymcarockies.org

Instagram: snowmountainranch

